

General Specifications for Roller Blinds

PART 1 – GENERAL

1.01 SUMMARY

- A. This section includes specifications for the following:
 - 1. Veromed® Roller blind fabrics & Verotec header system for Hospitals.
 - 2. Roller system hardware for manual & motorized 230V systems.

1.02 PERFORMANCE REQUIREMENTS

- A. Roller Fabrics: Provide Roller fabrics with the following minimum characteristics:
 - 1. Fabrics are inherently antimicrobial with silver Ion's inside the fiber polymer.
 - 2. Fabrics are inherently flame retardant based on fiber construction

1.03 SUBMITTALS

- A. Shop Drawings: Show layout and types of roller blind systems, sizes of Roller Blinds & operation.
- B. Maintenance Data: We Submit fabric manufacturer's standard maintenance procedure documentation and manual.
- C. Certificates: We Submit certificates from independent certified labs confirming the antimicrobial and flame retardancy properties of the fabrics
- D. Check list: We Submit a checklist for the submissions

1.04 PROJECT CONDITIONS

- A. Environmental Limitations: Do not install curtains until spaces are enclosed and weatherproof, wet work in spaces is complete and dry, work above ceilings is complete, and ambient temperature and humidity conditions are maintained at the levels indicated for the area when occupied for its intended use. Coordinate and get approval from the Client before commencing installation.
- B. Field Measurements: Verify dimensions by field measurements before fabrication and indicate measurements on Shop Drawings. Coordinate and get approval from the Client before commencing installation.
- C. Access to Facilities: Coordinate with the Facility Management team prior to any site visit.

1.05 WARRANTY

- A. Provide copy of manufacturer's standard warranty against the antimicrobial, fire retardant & stain resistant properties, for a minimum of 5 years from the date of installation.

General Specifications for Roller Blinds

PART 2 - PRODUCTS

2.1 MATERIALS

2.1A Roller Blinds Fabric

A1. Fabric:

1. Provide 100% Trevira CS Prosan Biological active fabric. Based on Silver Ion technology.
2. Fabric is to be opaque, inherently antimicrobial, washable, flame retardant and closely woven. Surface treated fabrics are not acceptable.
3. Minimum weight of the fabric: 270g/sqm
4. Width of fabric: minimum 2.8m

A2. Pattern & Color:

1. Solid or patterned fabric from manufacturer's standard selection, selected by the Client

A3. Antimicrobial Treatment:

1. The curtain fabric to be inherently and permanently antimicrobial.
2. A Silver based antimicrobial agent to be firmly anchored within the fiber polymer.
3. Surface treated fabrics are not acceptable
4. The fabric should conform one of the following standards:
 - Textile Product certifications from independent international institutes.
 - **ISO 20743:2013 "Textiles – Determination of antibacterial activity of textile products".
Deactivation of Multi resistant Bacteria's.**
 - **ISO 18184:2019 "Textiles – Determination of antiviral activity of textile products".
Deactivation of Corona & POX viruses.**
 - **Oecotex 100 certificate – Tested for harmful substances.**

A4. Flame Retardancy:

1. The fabric should conform to one of the following standards:
 - NFPA 701 "Standard Methods of Fire Tests for Flame Propagation of Textiles and Films"
 - DIN 4102/B1 "Fire testing To Building Material"
 - British Standard BS-5867

2.1C Roller Blind Header

C1. Product Characteristics

1. Extruded Aluminum header tube with reinforced profile to avoid bending not more than 1 mm.
2. Tube diameter not less than 43 mm diameter with stabilizer profiles inside.
3. The header tube to be closed on both ends (Control end & plunger end)
4. Manual control via stainless steel chain operated open/close system
5. Fixed to walls or ceilings
6. Powder coated Aluminum bottom bar with caps on both ends
7. Load capacity: Minimum 2kg/linear meter

General Specifications for Roller Blinds

C2. Roller Blind System Schematic

A schematic for the Roller Blind system is shown below for general information & understanding only. We provide complete details of their Roller Blind system for Client review & approval.

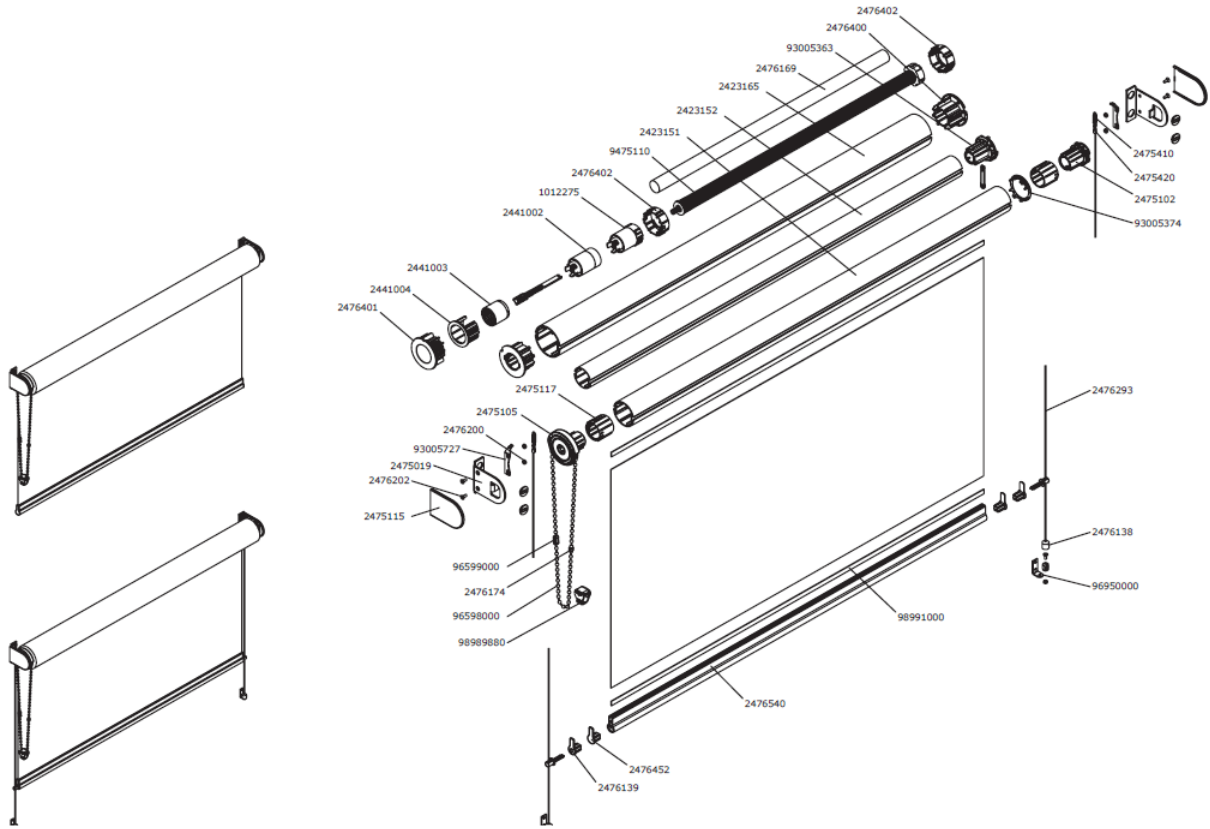
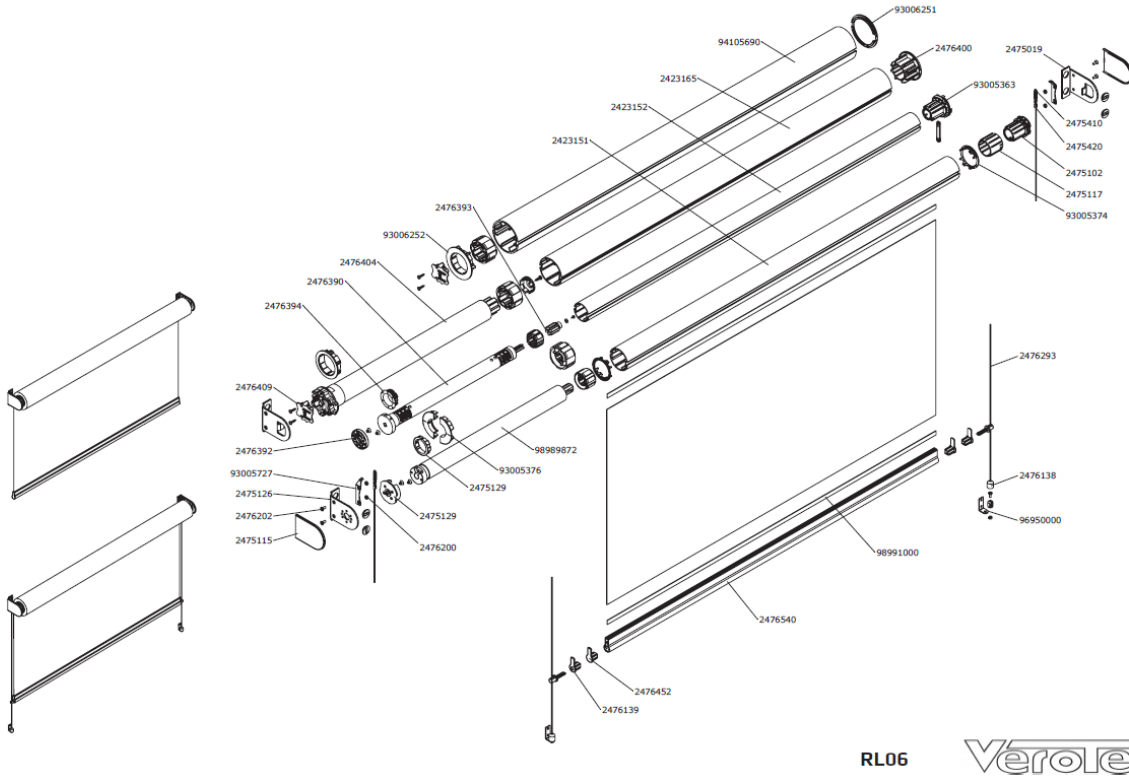

Figure 1: Schematic of manual Roller Blind System





RL06



Figure 2: Schematic of motorized Roller Blind System

2.2 FABRICATION

A. Roller Blind System:

1. Width: Equal to header length from which Roller Blind is hung. Different diameter tube for different widths. From 43 mm standard width until 120 mm until 5m width.
2. Length: Equal to header to floor height or windowsill height, as per site requirement and Client approval.

PART 3 – EXECUTION

3.01 INSTALLATION

- A. General: Obtain Client approval prior to making any preparations for installation.
- B. Guidelines for installation of Roller Blind System:
 1. Follow manufacturer guideline and site conditions

END OF SECTION